

New Kent Courthouse

The Village of New Kent is in the heart of the County and the center for governmental functions and community commerce.

The historic village should be a unique destination for residents and visitors. Character features include scenic vistas, landscaped entrance corridors, public green spaces, historic architecture, comfortable pedestrian access, and a dense development pattern of businesses and residential uses.

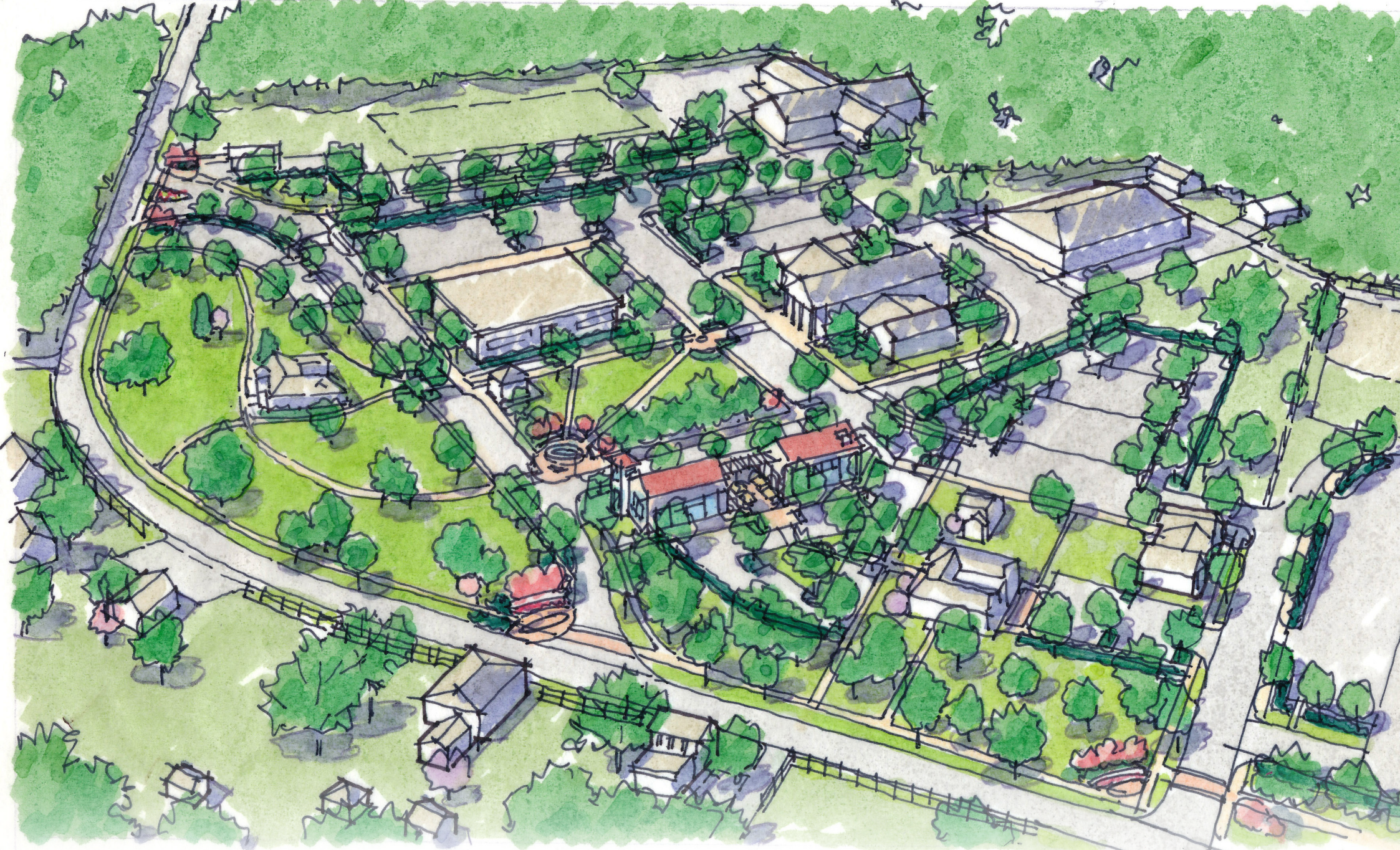

Above: Perspective aerial view of New Kent Courthouse showing governmental center with landscaped corridor and new green courtyard framing historic buildings. Note the connected walkways and areas for interpretive displays. Parking near government center and historic jail has been carefully tucked to side areas and shared lots. Historic buildings are integrated with new uses and activities in outdoor spaces. Enhanced trail system connects pedestrians to nearby retail center.

New Kent Courthouse Characteristics

Uses	<ul style="list-style-type: none"> Public and government services Commercial retail Restaurants Office and service businesses Residential, diverse types
Building Types	<ul style="list-style-type: none"> Institutional & governmental Small commercial Single-family residential (small) Multi-family residential (above business or low-density group)
Public Spaces	<ul style="list-style-type: none"> Green common spaces for gathering Landscaped streets and frontages Interpretation of historic places Attractive, pedestrian scale lighting Coordinated signage & wayfinding Parking pavement minimal, selective on street, small lots landscaped and shared for common access, oriented to side or rear
Connectivity	<ul style="list-style-type: none"> Connected paths and walkways Pedestrian oriented business areas Comfortable vehicular circulation
Activity	<ul style="list-style-type: none"> Communication and social center Celebration and event spaces



Village green frames public buildings



Interpretation of historic places



Historic buildings and residential uses



Dense mixed-use commercial center